

ISOVER ARENA

Water repellent, thermal and Acoustic insulation of mineral wool. The material consists of bio soluble glass fibers bonded in a thermosetting resin with uniform texture. For vertical enclosures of facades and internal partitions, presented in semi-rigid panels.

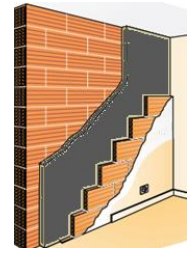

END USE CHARACTERISTICS AND LIMITATIONS

The product is designed as thermal and acoustic insulation in vertical enclosures of facades and internal partitions, with an excellent performance in partitions with metal structure and laminated plasterboard solutions.

Isover Arena reduces the transmission of vibrations based on the principle mass-spring-mass, characterized by a high elasticity of panels, which works as a shock absorber.

The product is designed to be installed and handled easily and keeps its performance without dust detachment.

Product classified UL 723 File R25157.

Product certified by LAPEM (Tests, equipment and material laboratory, Mexico).

PRODUCT SPECIFICATION

PRODUCT	LENGTH mm	WIDE mm	TICKNESS mm	NET WEIGHT ± 10% kg/m ² (g/ft ²)
ISOVER ARENA 40	15240 + 300mm	1220 ± 3mm	40 ± 2 mm	0.83 (77)
ISOVER ARENA 60	10160 + 300mm	1220 ± 3mm	60 ± 2 mm	1.25 (116)
ISOVER ARENA 70	10160 + 300mm	1220 ± 3mm	70 ± 2 mm	1.06 (99)
ISOVER ARENA 80	7620 + 300mm	1220 ± 3mm	80 ± 2 mm	1.22 (113)
ISOVER ARENA 90	7620 + 300mm	1220 ± 3mm	90 ± 2 mm	1.37 (127)

PROPERTIES	STANDARD	40 mm	60 mm	70 mm	80 mm	90 mm
Short term water absorption	EN-1609	≤ 1 kg/m ²	≤ 1 kg/m ²	≤ 1 kg/m ²	≤ 1 kg/m ²	≤ 1 kg/m ²
Thermal Performance (Thermal conductivity – Mean Temp. 75°F / 24°C)	ASTM C411	0.035 W/m.°C 0.24BTU.in/ hr.ft ² .°F	0.035 W/m.°C 0.24BTU.in/ hr.ft ² .°F	0.0378 W/m.°C 0.26BTU.in/ hr.ft ² .°F	0.0378 W/m.°C 0.26BTU.in/ hr.ft ² .°F	0.0378 W/m.°C 0.26BTU.in/ hr.ft ² .°F
Thermal performance (Thermal resistance)	ASTM C518	114 m ² .°C /W 6.5 hr.ft ² .°F /BTU	171 m ² .°C /W 9.7 hr.ft ² .°F /BTU	185 m ² .°C /W 10.5 hr.ft ² .°F /BTU	212 m ² .°C /W 12 hr.ft ² .°F /BTU	238 m ² .°C /W 13.5 hr.ft ² .°F /BTU
Surface Burning Characteristics	ASTM E84 / UL723	Flame Spread Index <25 Smoke Developed Index <50	Flame Spread Index <25 Smoke Developed Index <50	Flame Spread Index <25 Smoke Developed Index <50	Flame Spread Index <25 Smoke Developed Index <50	Flame Spread Index <25 Smoke Developed Index <50
Corrosiveness	ASTM C665 /C795	It does not generate or accelerate corrosion on: steel, iron, copper or aluminum	It does not generate or accelerate corrosion on: steel, iron, copper or aluminum	It does not generate or accelerate corrosion on: steel, iron, copper or aluminum	It does not generate or accelerate corrosion on: steel, iron, copper or aluminum	It does not generate or accelerate corrosion on: steel, iron, copper or aluminum
Fungi Resistance	ASTM C1338	Meets requirements	Meets requirements	Meets requirements	Meets requirements	Meets requirements
Acoustic absorption AW	CTE (AW)	AW: 0.70	AW: 0.80	Not available	Not available	Not available
Odor Emissions	ASTM E96 Method A	Meets requirements	Meets requirements	Meets requirements	Meets requirements	Meets requirements
DBE Content	Oregon State	FREE, meets requirements	FREE, meets requirements	FREE, meets requirements	FREE, meets requirements	FREE, meets requirements

OTHER PROPERTIES:

Specific heat apx. (Cp)	J/kg.K	800
Water vapor resistance (MU)	-	1
Reaction to fire	Euroclass	A1
Water absorption (WS)	-	Non- hydrophilic
Resistance to air flow (AF)	kPa.s/m ²	> 5

(*) Non-hydrophilic: Does not easily absorb moisture or water

VISUAL STANDARD

CHARACTERISTIC	ACCEPTANCE GUIDE
Color	The product is gray-black color, slight variations allowed in the key, which do not affect the thermal performance.
Surface Appearance	No rips and breaks are accepted. Surfaces generally must be uniform without patches Bakelite. The ground material agglomeration, in general, is not accepted, however, an occasional patch inside a sheet does not damage its performance, unless it produces delamination of the product. Neither protuberances or cracks greater than 3 mm (1/8 inch) in height or depth, nor more than 25 mm (1 inch) in width or diameter are not accepted. The board should be easy to cut with tools with a reasonable edge; Speckles must not produce on the blade, neither must wool crumble. It must be a clean cut with an uniform surface.

PACKAGING

PRODUCT	m ² /roll	TOTAL NET WEIGHT ± 10% (kg/Package)
ISOVER ARENA 40	18.59	15.5
ISOVER ARENA 60	12.39	15.5
ISOVER ARENA 70	12.39	13.2
ISOVER ARENA 80	9.29	11.3
ISOVER ARENA 90	9.29	12.7

Polyethylene shrink-package roll extreme open and auto-adhesive label. 1 roll/package.

GROSS WEIGHT (kg/package) = NET WEIGHT (kg/package) + 0.3 kg approx.

RECOMMENDATIONS

- ✓ Do not store the material outdoor.
- ✓ Keep the product in its original packaging until it is installed.
- ✓ The cut can be made with a knife.
- ✓ The product must not be compressed.
- ✓ Make sure that the mechanical fixings that are used are appropriate and safe to install the panels against the wall.

RECYCLED CONTENT

(1) PI Recycled Content: Post Industrial Recycled Content: Collected from manufacturers or industry.

(2) PC Recycled Content: Post-Consumer Recycled Content: Collected from end uses.

TOTAL RECYCLED CONTENT	POST INDUSTRIAL RECYCLED CONTENT (1)	POST CONSUMER RECYCLED CONTENT (2)
74.1%	74.1%	0 %



N° CO11/4442

Sistema de Gestión de la Calidad para la producción y venta de membranas impermeabilizantes modificadas (mantos, con o sin recubrimiento autoprotector) y emulsiones asfálticas, Cielo rasos en fibra de vidrio con acabado decorativo, Láminas y rollos flexibles en fibra de vidrio para la fabricación y recubrimiento interno y externo de conductos para transporte de aire acondicionado, Aislamientos térmicos y acústicos rígidos, flexibles y preformados.

**Norma - ISO 9001:2015**

Producto fabricado bajo un sistema de administración de calidad certificado de conformidad con ISO 9001.

Reported values are typical of tests carried out on samples taken from standard production and may be update without notice.

The user is responsible for determining if the product is recommended for a particular surface and if it satisfies the application requirements. The user must make application testing and product testing required for that purpose.

Not controlled copy. Information on this document may be updated without notice.

Last Update: July 18th/2019